



City of Parkland Planning and Zoning Department

6600 University Drive
Parkland, FL 33067

Phone (954) 753-5040
Fax (954) 341-5161

STAFF USE ONLY

Intake Date: _____ By _____
Fee Paid: _____ Receipt # _____
Case #: _____
 Administrative review only (sec.22-204H.)
 Commission review only (sec. 22-199 J.2)
 Full review process (sec. 22-199 J.1)

ANTI-MONOTONY APPLICATION

INSTRUCTIONS TO APPLICANTS:

1. Please complete all information on the application and provide attachments.
2. Please provide a location map showing subject property, adjacent lots and surrounding lots. The location map must show at least two (2) lots on either side of subject property and three (3) lots directly across from subject property.
3. Please provide the following information for **ALL** adjacent properties and surrounding properties building elevation, body paint color, trim paint color, roof color, and roof style. Map required must show listed information. (photographs of surrounding homes). Identify vacant lots, if applicable.
4. Please provide paint chips or samples and material specifications as applicable for proposed changes to residence.
5. Please provide the following information for existing condition and adjacent properties.

I. PROPERTY OWNER/APPLICANT INFORMATION

Property Owner(s) of Record: Centerline Capital Advisors
 Address: 15481 SW 12th Street # 309 City: Sunrise ST: FL ZIP: 33326
 Phone: 954-444-7741 E-Mail Address: Permits@brownsp permitting.com

Applicant (if other than owner): NVR Inc., dba Ryan Homes
 Address: 1450 Centrepark Blvd City: West Palm Beach ST: FL ZIP: 33401
 Phone: 561-275-2730 E-Mail Address: Permits@brownsp permitting.com

II. PROPERTY LOCATION & INFORMATION

- A. Folio Number: [][]--[][]--[][]--[][]--[][]--[][]--[][]--[][]
- B. Community: The Falls
- C. Subdivision: McJunkin Farms Plat
- D. Property Address: 7930 Rowan Terrace
- E. Property Lot/Block: Lot 9 Blk 3
- F. Model/Elevation: Gorda Cay-B/R
- G. House Color/Trim: Lazy Gray/Snowbound H. Roof Color/Style: Sterling

LOT 5 BLOCK 5 MODEL-ANTIGUA-ITAL-R SCHEME: 15
LOT 4 BLOCK 5 MODEL-PALMETTO-ITAL-R SCHEME: 11
LOT 3 BLOCK 5 MODEL-ST LUCIA-ITAL-R SCHEME: 9
LOT 2 BLOCK 5 MODEL-ST LUCIA-SPAN-R SCHEME: 4
LOT 1 BLOCK 5 MODEL-ST.LUCIA-ITAL-R SCHEME: 8

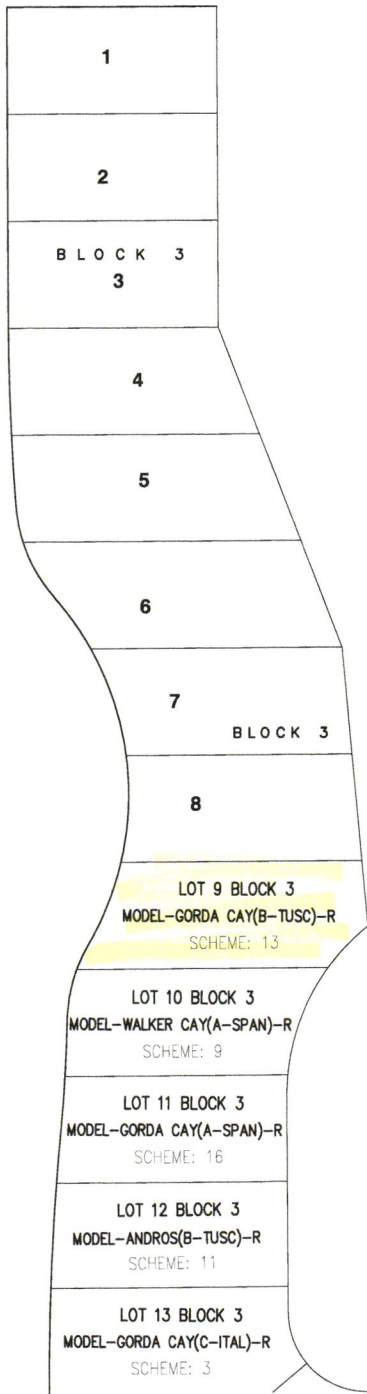
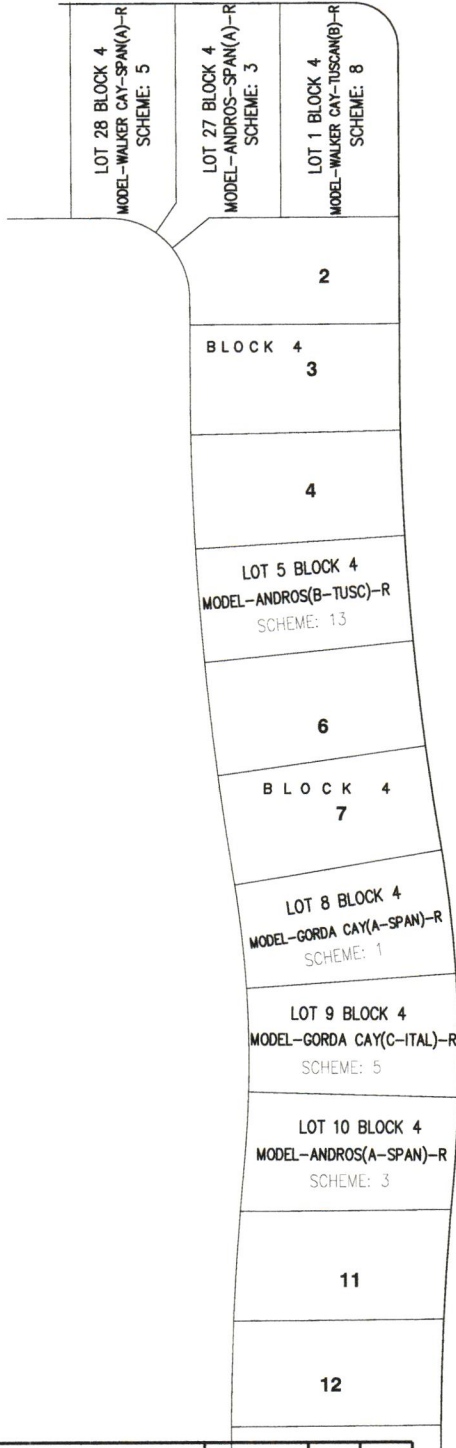

ANTI-MONOTONY EXHIBIT LOT	3-15-19	SMP	
REVISIONS	DATE	BY	CK'D
JOB NO. 8347-H	DWG. BY: SMP	SCALE: N/A	ANTI-MONOTONY EXHIBIT
PARKLAND FALLS	CH'D BY: SMP	DATE: 2019	SHEET 1 OF 1 SHEET